



ULTIMA®

Installation Instructions for Ultima® Microphone & Monitor Arm Mounting Solutions

The Ultima® line of microphone and monitor broadcast equipment by O.C. White Co. includes both ULP ("Ultima Low Profile") and SMS ("Scalable Monitor System") models.

This instructional manual covers a range of topics, from setting up the equipment to adjusting the spring tension of the arms. With this manual, users can confidently utilize the advanced features of the Ultima® line to produce high-quality broadcast audio and video content.

Register Your Product To Activate Your Warranty

support.ocwhite.com/product-registration/

www.ocwhite.com | support.ocwhite.com

MOUNTING - ULP & SMS (Not Scalable)

CLAMP AND GROMMET MOUNT (ULP-CLAMP-13)

1A. For installation on open edge of work surface:

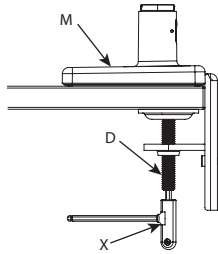

- i. Slide Mount (M) against work surface edge and fully tighten Clamp screw (D) with Hex Key (X).

1B. For installation through a 3" grommet hole:

- i. Insert Mount (M) through Grommet (G) and against work surface edge. Position Mount so that front of Base faces the user. Fully tighten Clamp Screw (D) with Hex Key (X).

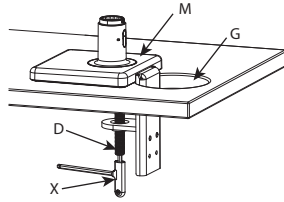

NOTE: If grommet hole is less than 3", the clamp will need to be separated as seen in step 1C.

If grommet hole is less than 2", a Bolt-Through Mount is required.

1C. For installation on work surface positioned against a wall or panel:

- i. Detach the Bottom Clamp (A) from the Top Bracket (B) by loosening Bracket Screw (C) with Hex Key (X).

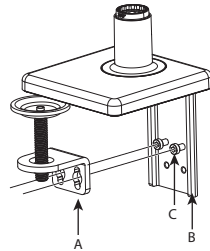

- ii. Position the Top Bracket against work surface edge.

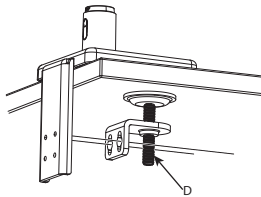

- iii. Underneath the work surface, reattach the Bottom Clamp to the Top Bracket using the Bracket screws.

- iv. Fully tighten the Clamp Screw (D) with Hex Key (X).

NOTE: Clamp Mounts cannot be used to mount the Ultima® to any vertical surface.

MOUNTING - ULP & SMS (Scalable)

CLAMP AND GROMMET MOUNT

(15000-13, 15000-18-13, 15000-24-13, 15000-30-13)

2A. For installation on open edge of work surface:

- i. Slide the Base with Clamp Mount (A) against work surface edge and fully tighten Clamp Screws (B) with Hex Key (C).

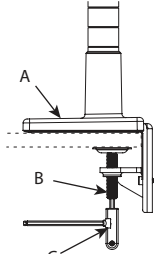

2B. For installation on work surface positioned against a wall or panel:

- i. Detach the Clamp Foot (E) from the Clamp Bracket (F) by loosening Bracket Screws (D) with Hex Key (C).
- ii. Position the Clamp Bracket against work surface edge.
- iii. Underneath the work surface, reattach the Clamp Foot to the Clamp Bracket using the Bracket Screws.
- iv. Fully tighten the Clamp Screws (B) with Hex Key.

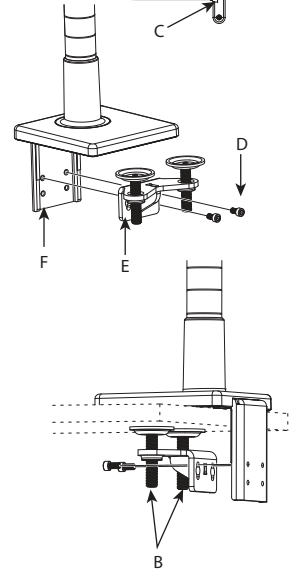

2C. For installation through a 3" grommet hole:*

- i. See step 1B - i to remove Clamp.
- ii. Position the Clamp Bracket (F) in Grommet Hole (G) and against the inside edge. Position Base (A) so that the front is facing the user.
- iii. See steps 1B - iii, iv to reattach Clamp.

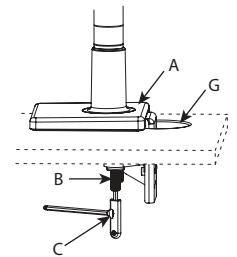

* If grommet hole is less than 3" a Bolt-Through mount is required.

CAUTION: Clamp Mounts cannot be used to mount the Ultima® to any vertical surface.

BOLT-THROUGH MOUNT

2D. For installation on a work surface with no access for a clamp system:

Skip to step iii, if the Clamp Mount is not attached.

- i. See steps 1B - i, ii to remove Clamp Mount.

- iii. Remove the Post Bolt (N) from under the base using the Hex Key (O).

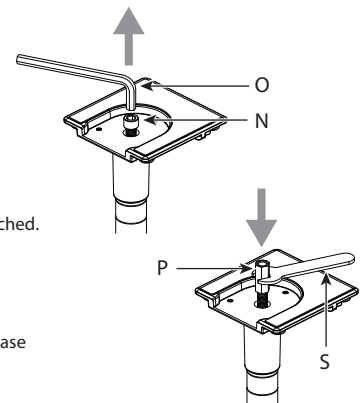

Note: The Bolt-Through Mount may also be accommodated by a larger drilled hole or grommet hole up to 3" in diameter for cable management (C) behind the arm and through the hole to the underside of the work surface.

iv. Pass the Bolt-Through Adapter (P) through the base and into the Post. Use the Wrench (S) to tighten the adapter.

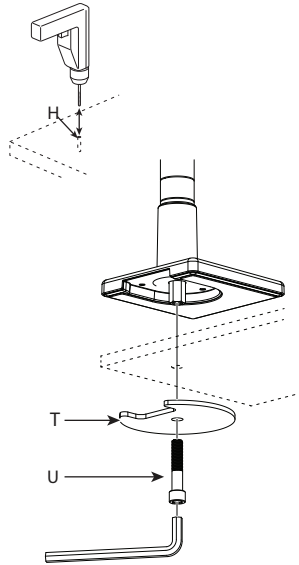

v. Drill a hole (1/2") through the work surface in the desired location.**

vi. Position the Base over the Hole (H).

vii. Align Bolt-Through Plate (T), foam side up, under the work surface. Pass the Bolt (U) through the hole in the plate and screw into the Bolt-Through Adapter (P) using the 10mm Hex Key (O).

PRO STOP™ ROTATIONS 360° 180° 90° (ULP & SMS)

Position the Pro Stop™ control ring to limit the arm's range of motion. The marked angle will be in the center of the range of motion. The Pro Stop™ control rings must be configured in such a way that the monitor does not pass behind the rear edge of the unit.

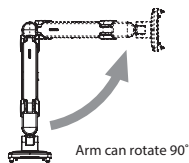
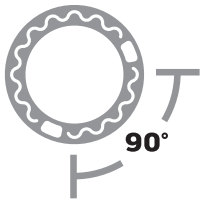
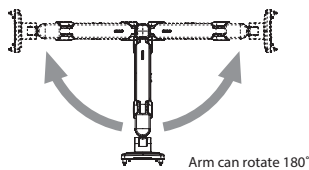
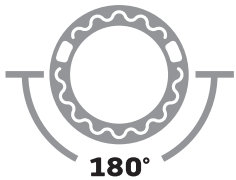
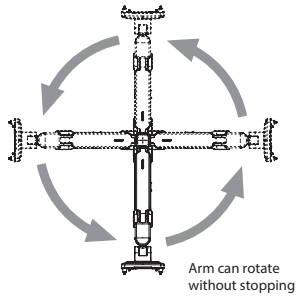
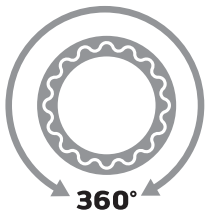
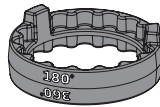

INTERGRATED CABLE MANAGEMENT SYSTEM (ULP & SMS)

A. Route cables through the flexible cable clips on the upper wire management channel (A).

B. Slide the plastic cover on the lower wire management channel upward until it disengages, then remove (B).

C. Route cables inside the lower wire management channel (C) and replace cover, slide downward until it clicks into place.

D. Push cables into the flexible fingers of the cable management clip (D).

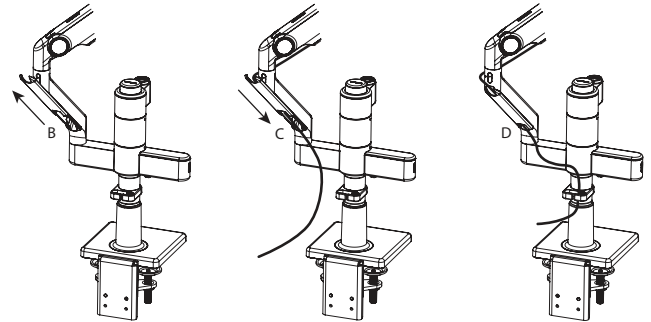
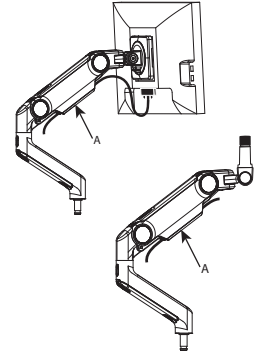

Note: 45° Fixed Angle Arm shown above has lower wire management channel. All ULP & SMS offerings have upper wire management channel (front facing).

BRACKET ASSEMBLY AND CABLE CLIP (ULP & SMS)

DUAL BRACKET CLAMP - Example Uses (PMB-2-13)

*Single Bracket Clamp (PMB-1-13) for SMS or ULP

3A. For Single and Dual Monitor applications.

i. With the Lever (B) fully open, position the Dual Bracket (A) in desired location along the Post (C).

ii. Close the Lever fully.

iii. If you are using a second monitor, lift and remove the Cover (D).

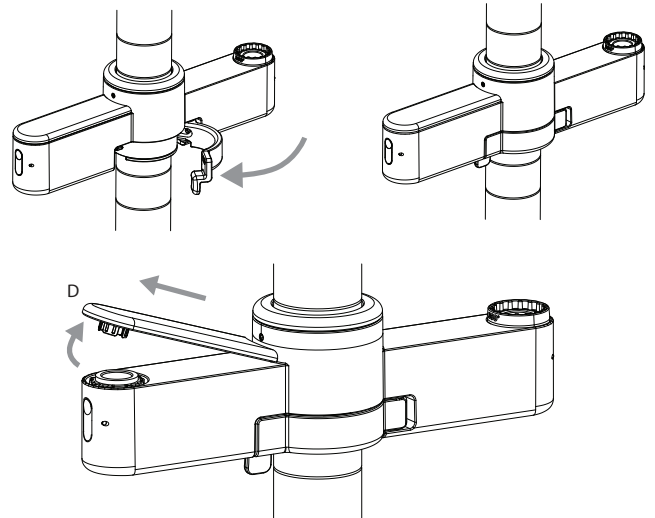
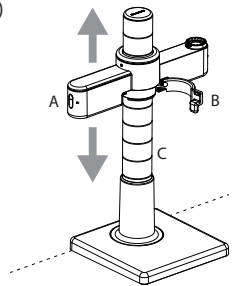

**TRIPLE ARM MOUNTING
(PMB-2-13 + PMB-3-13 / PMB-VESA-13)**

3B. For Triple Monitor applications

- i. Remove the two set screws (E) that retain the Bracket Cap (F).
- ii. Place the Post Mounting Bracket (PMB-3-13 or PMB-VESA-13) (G) on top of the Dual Bracket facing the user, insert the Tabs (J) into the Pockets (K).
- iii. Replace the Set Screws (E) and tighten until the Post Mounting Bracket is secure and the screws are flush with the surface.
- iv. Insert the Bracket Cap into the top of the Post Mounting Bracket and push until it clicks into place.

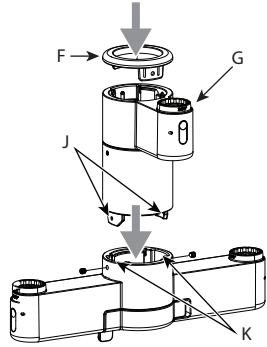
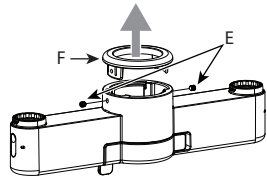

CABLE MANAGEMENT CLIP

- i. Spread the Cable Management Clip around the Post in the desired location.
- ii. Press the two sides together until Hoop (L) engages.

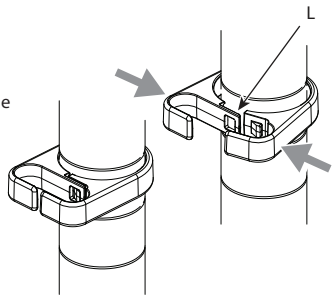

ADJUSTING BRACKET CLAMP TENSION (ULP & SMS)

Ultima® arrives ready for use, however it may become necessary to adjust the bracket clamp.

- A. Detach all cables, monitors, microphones, monitor arms, and microphone arms.
- B. Open the Lever (A) all the way.
- C. Turn the Adjustment Screw (B) clockwise ¼ of a turn using the Hex Key (C).
- D. Test your adjustments by closing the lever.

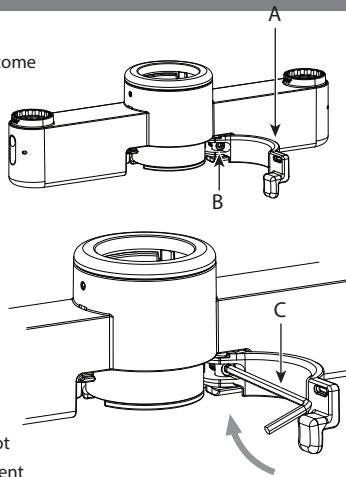

CAUTION: If the lever is difficult to close or will not close fully, it is over-tightened. Turn the Adjustment screw counter-clockwise slightly. Forcing it closed will cause damage to bracket clamp.

ATTACH ARMS TO BRACKET & BASE (ULP & SMS)

Before adding each arm, position the Pro Stop™ control ring to control the arm's range of motion, see Pro Stop™ Rotations. The installation order of arms must not allow the monitor to pass behind the rear edge of the unit.

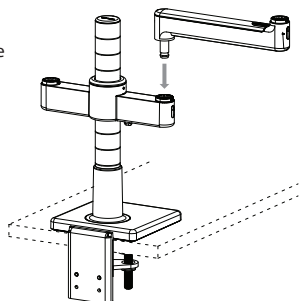

- i. Insert the first arm into the mount until release button locks in place.
- ii. Insert the second arm into the straight channel until release button locks in place.
- iii. To remove an arm, press the release button and lift upward near the joint.

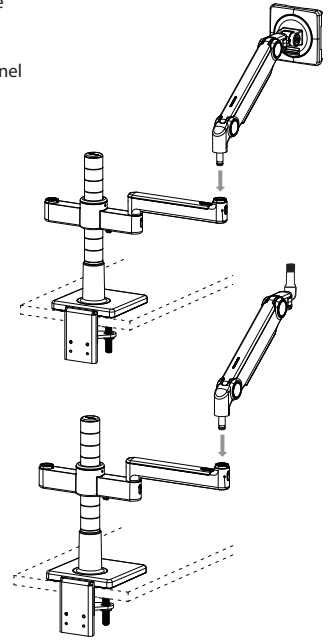
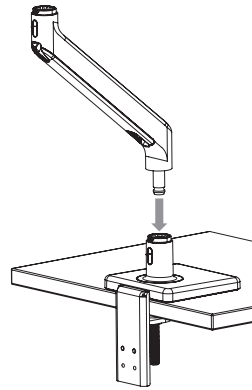

ARM SPRING TENSION ADJUSTMENTS (ULP & SMS)

WEIGHT ADJUSTMENT

Your monitor should move up and down easily and stay in place once adjusted.

If the monitor moves down from the adjusted position, or is hard to lift you should **INCREASE** the counterbalance tension. (Spring Tension Balance Gauge).

If the monitor rises up from the adjusted position you should **DECREASE** the counterbalance tension.

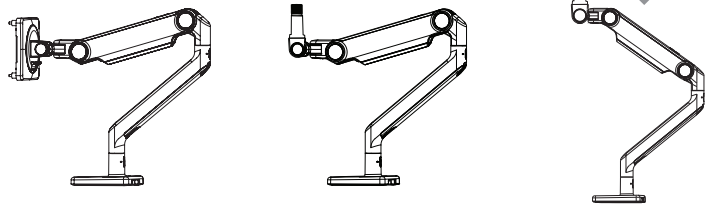

Ultima® ADJUSTMENT

- A. Push the Upper Arm wire management channel (A) downward until the Adjustment Screw (S) is visible.
- B. Using the Hex Key turn the Adjustment Screw clockwise (towards +) to increase the load tension, and counter-clockwise (towards -) to decrease the load tension.
- C. Turn the Adjustment Screw (S) until the Monitor is properly balanced.
- D. Move the monitor around to ensure that the motion is smooth and the arm functions as intended and holding the monitor in place.

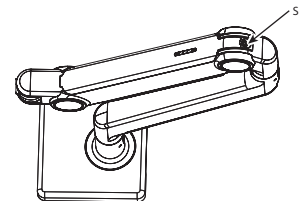

CAUTION: Do not over-tighten the Adjustment Screws as it can damage the Arms and will void the warranty.

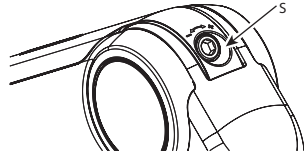

*Individual Monitors Should Not Exceed:
15 lbs

*Total Weight of All Monitors Not To Exceed:
90 lbs

ATTACH VESA BRACKET TO MONITOR (SMS ONLY)

- Remove the plastic top cover.
- Place VESA bracket in position on back of monitor with two cutouts (U) in vertical direction and attach using 4 screws provided. VESA bracket can accommodate 75mm or 100mm hole patterns. For this, you may also use screws that came with your monitor.
- If mounting space for 75mm VESA bracket is inset into back of monitor, place the 4 plastic spacers (S) between VESA bracket and monitor (align with hole pattern), and using the extended VESA screws (Y), attach through the spacers.
- Reinstall the plastic top cover.

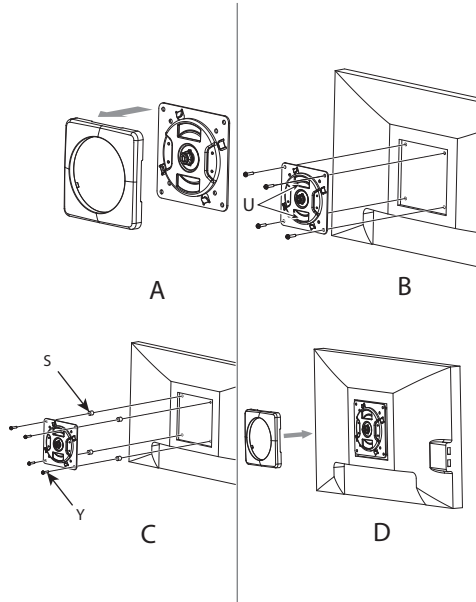

ATTACH MONITOR TO ARM (SMS ONLY)

Hold the monitor angled back, lower it to the arm. Align the VESA Bracket with the Arm and fit the Hook into the corresponding cutout in the VESA Bracket. Tilt the bottom of the monitor back until the Quick Release Tab on the arm snaps into position.

To remove the monitor, lift the Quick Release Tab and pull the bottom of the monitor away from the arm, then lift free of the hook.

NOTE: If needed, adjust tension screws (A) to hold monitor in desired position.

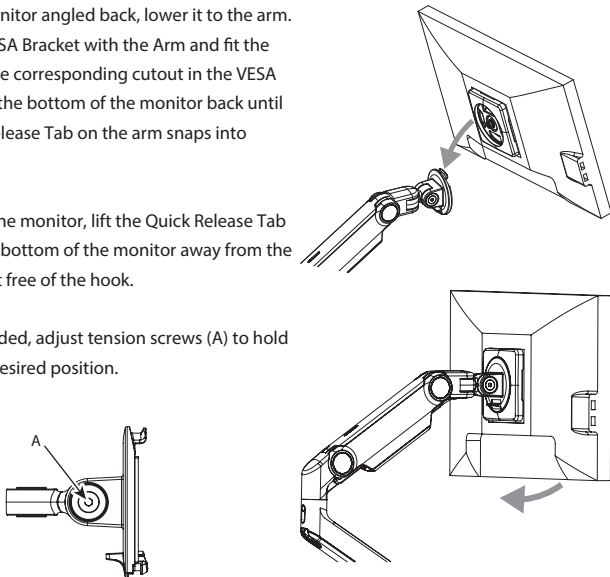

ADDING VERTICAL EXTENSION TO RISER (ULP & SMS)

- Remove Top Cap from originally mounted post
- Attach second Post to top of first Post:
 - Posts must be fully seated against each other.
 - Place Top Cap on top of second post.

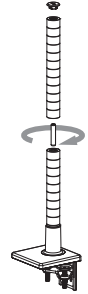

EXTENDING ARM REACH (ULP & SMS)

Before extending arm, set the angle control adjustment to either 360°, 180°, 90°.

- Insert the first arm into the mount until release button locks in place.
- Insert the extension arm into the mount until release button locks in place.
- Insert the second arm into the straight channel until release button locks in place.
- To remove an arm, press the release button and lift upward near the joint.

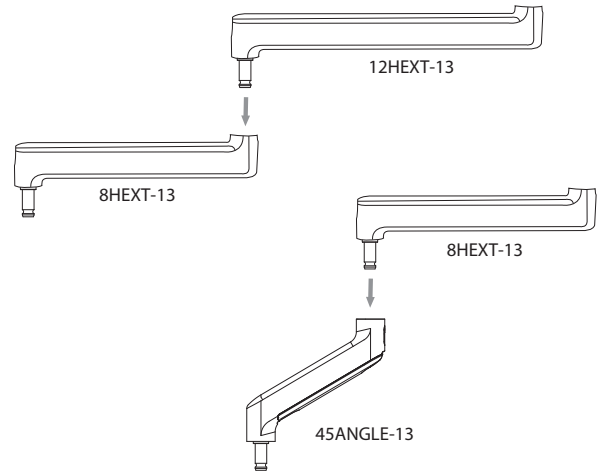

MONITOR INSTALLATION HARDWARE (SMS ONLY)

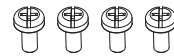

4 Standard VESA Bracket Screws



4 Plastic Spacers

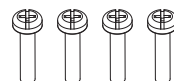

4 Extended VESA Bracket Screws

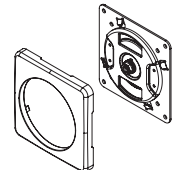

VESA Bracket

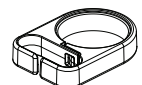

Cable Management Clip

CLAMP MOUNT INSTALLATION HARDWARE (ULP & SMS)

Clamp Mount: (ULP-CLAMP-13) (Not Scalable)

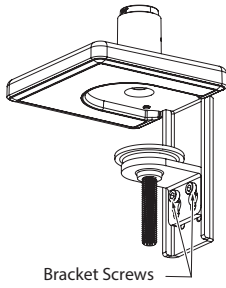

Bracket Screws

Clamp Mount: (15000-13, 15000-18-13, 15000-24-13, 15000-30-13) (Scalable)

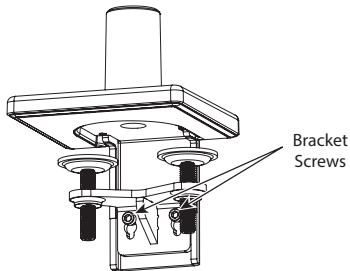

Bracket Screws

Bolt-Through Mount

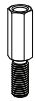

Bolt-Through Adapter



Bolt-Through Bolts

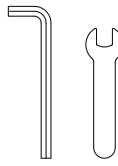

Hex Key

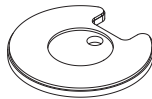

Bolt-Through Plate

OTHER NOTES: Hex Key can be found under the plastic base cover.

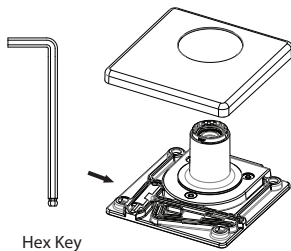

Hex Key

OTHER MOUNTING OPTIONS (ULP & SMS)

ProBoom® Ultima® Gen2 Machined Table Bushing with nut & washer (MB-13)

ProBoom® Ultima® Gen2 3" Machined Riser Assembly (14500-3-13)

ProBoom® Ultima® Gen2 6" Machined Riser Assembly (14500-6-13)

ProBoom® Ultima® Gen2 10" Machined Riser Assembly (14500-10-13)

ProBoom® Ultima® Gen2 Permanent Wall Mount Base Assembly (11426-13-B)

ProBoom® Ultima® Gen2 Permanent Screw Down Base Assembly (11427-13-B)

ProBoom® Ultima® Gen2 EPS 12" Tall 4-Way Modular Clamp Base Assembly (15000-13) requires (PMB-1-13) or (PMB-2-13)

ProBoom® Ultima® Gen2 EPS 18" Tall 4-Way Modular Clamp Base Assembly (15000-18-13) requires (PMB-1-13) or (PMB-2-13)

ProBoom® Ultima® Gen2 EPS 24" Tall 4-Way Modular Clamp Base Assembly (15000-24-13) requires (PMB-1-13) or (PMB-2-13)

ProBoom® Ultima® Gen2 EPS 30" Tall 4-Way Modular Clamp Base Assembly (15000-30-13) requires (PMB-1-13) or (PMB-2-13)

Add Single Monitor on Ultima® Gen2 #15000-13 (Any Height) Base Assembly (PMB-1-VESA-13)

RECOMMENDED ORDER OF OPERATION

(ULP) Microphone

- 1.) Attach mount to work surface
- 2.) Position Pro Stop™ Rotations for preferred angle control
- 3.) Attach arm to base stem
- 4.) Remove cable management channel, tuck cable in channel, slide channel back on
- 5.) Make arm adjustments if necessary

(SMS) Monitor (Not Scalable)

- 1.) Attach mount to work surface
- 2.) Position Pro Stop™ Rotations for preferred angle control
- 3.) Attach arm to base stem
- 4.) Attach VESA bracket to monitor
- 5.) Attach monitor to arm
- 6.) Remove cable management channel, tuck cable in channel, slide channel back on
- 5.) Make arm adjustments if necessary

(SMS) Monitor (Scalable)

- 1.) Attach mount to work surface
- 2.) Slide bracket assembly and cable clip onto riser
- 3.) Position Pro Stop™ Rotations for preferred angle control
- 4.) Attach arm to bracket
- 5.) Attach VESA bracket to monitor
- 6.) Attach monitor to arm
- 7.) Remove cable management channel, tuck cable in channel, slide channel back on
- 8.) Make arm adjustments if necessary

www.ocwhite.com | support.ocwhite.com

© 2023 O.C. WHITE CO. The text and artwork are copyrighted materials. All rights reserved. The O.C. WHITE and ULTIMA® mark and logo are registered trademarks of O.C. WHITE CO. and are registered in the United States and certain other countries.

SMS-LIT2